



## Vacuum cleaner FVC 35 M.

Universal wet and dry  
vac for virtually dust  
free applications.



# Universal wet and dry vac for virtually dust free applications.

Adjustment of the suction power to the connected device. (21 for fischer hollow drill bit FHD).

## Main switch

0 = vacuum cleaner switched off

I = vacuum cleaner switched on, automatic filter cleaning off

IR = vacuum cleaner switched on, automatic filter cleaning on

AR = vacuum cleaner switched on by connected electrical device, automatic filter cleaning on

Cable plug for automatic switch-on and switch-off coupling with the connected power tool.

Easy access to the filter allows clean and uncomplicated replacement of filter cartridges.

Robust, double-walled container ideal for use on construction sites.

Powerful vacuum motor for high suction performance.

High volume flow and negative pressure at the end of the hose for maximum dust extraction.

## Approval





# Advantages and functions

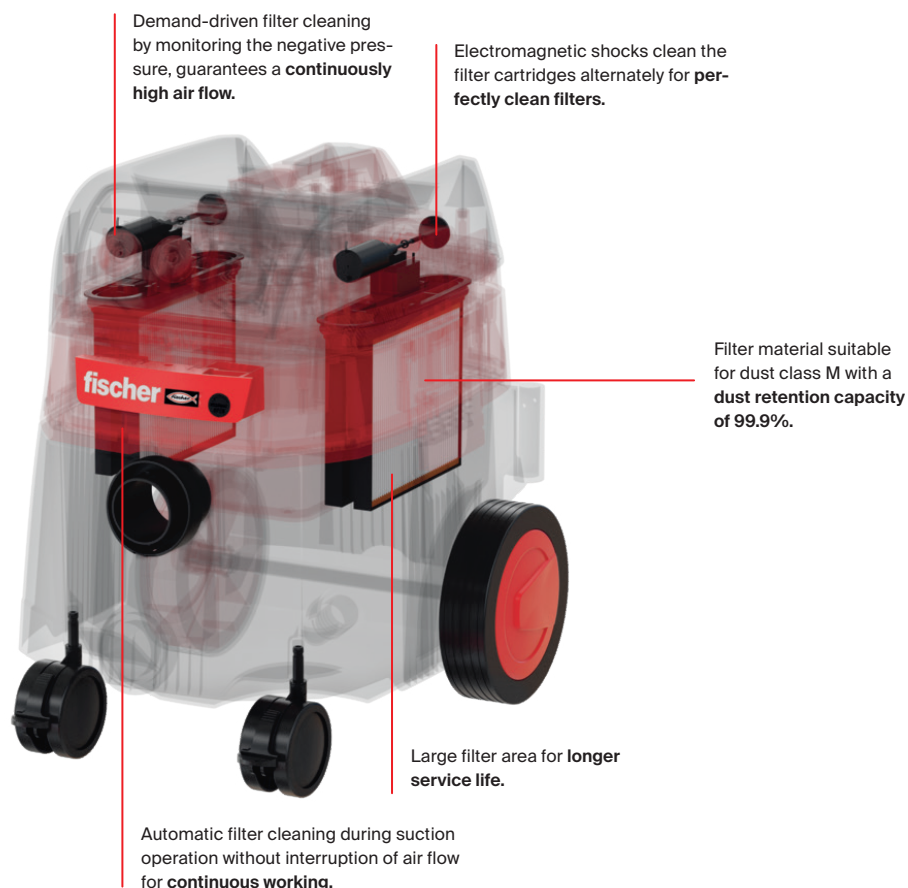

## Advantages at a glance

- Automatic filter cleaning during suction operation without any interruption enables non-stop suction.
- Vacuum cleaner filter with dust retention capacity of 99,9% according to dust class M, perfectly suited for use with the fischer hollow drill bit FHD.
- High performance motor for constantly high suction power.
- The matching cleaning set FVC AP enables dry and wet suction work.
- The sealable filter bags guarantee a dust-free disposal.
- The universal fischer service concept offers a seamless repair process worldwide.

## Functionality

- The power cable of the electrical device is plugged into the socket of the vacuum cleaner. This means that the vacuum cleaner only runs during the use of the device. The suction power can be adapted to the connected device by the left-hand switch.
- When the filter bag is full, the lamp to the right of the switches lights up. To change the bag, remove the upper part and replace the corresponding filter bag without creating dust.

# Applications and assembly

## Applications



Sawing



Sanding



Dry suction



Hollow drilling



Milling



Wet suction

## Assembly with fischer hollow drill bit FHD

Drill hole creation with the fischer hollow drill bit FHD not only ensures a low-dust working environment, but also considerable time savings. The use of hollow drill bits compared to conventional hammer drills enables fast drilling progress due to their sharp carbide plates.

Additional time can be saved due to the omission of borehole cleaning during the assembly of mechanical and chemical anchors. In addition, the costs for the cleaning equipment are eliminated, like e.g. cleaning brushes, blowers or compressed air cleaning equipment.

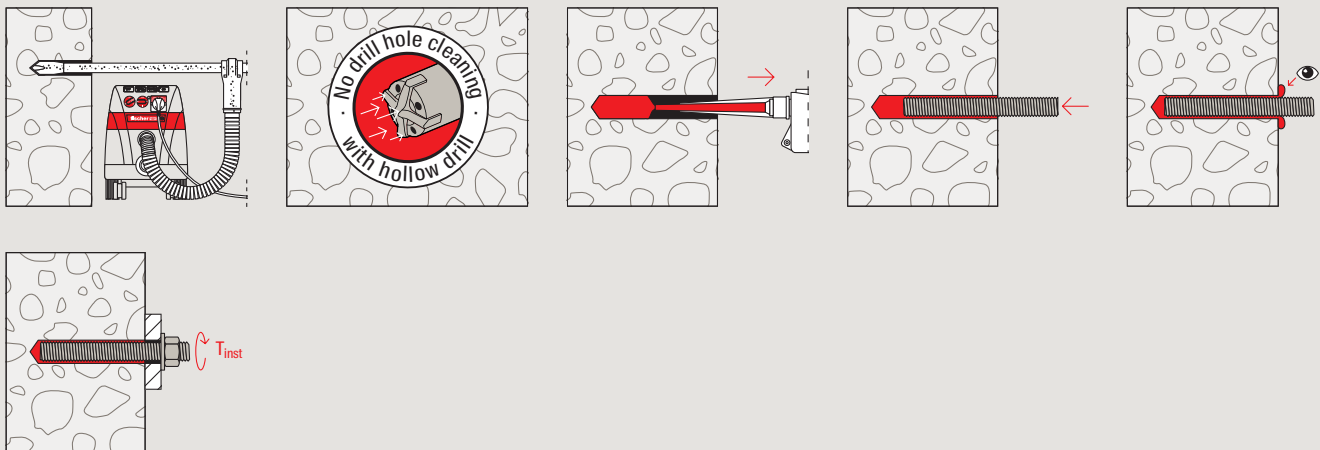

# Health hazard due to dust generation

## Dust concentration

In the construction industry, dust occurs during many different activities. Usually this involves mineral mixed dust, e.g. from sand, lime, gypsum, cement or concrete. This mixed dust partly contains quartz fine dust, which has a diameter of less than 1 µm and therefore belongs to the category of A-dusts. These dusts are so small that they reach the alveoli of the lungs and can lead from respiratory diseases to silicosis.

Therefore, the BG Bau (German trade association) lowered the workplace limit values in 2014 for A-dust from 3.0 to 1.25 mg/m<sup>3</sup> and for B dust to 10 mg/m<sup>3</sup>. For quartz fine dust, the limit value even lies at 0.05 mg/m<sup>3</sup>.

Common dust concentrations in the construction industry	A-dusts
Grinding drywall	28.9 mg/m <sup>3</sup>
Cutting plaster dry	19.2 mg/m <sup>3</sup>
Removal of plaster	9.1 mg/m <sup>3</sup>
Dry sweeping	8.4 mg/m <sup>3</sup>
Drilling in concrete	7.0 mg/m <sup>3</sup>
Open cabins for construction machinery	4.2 mg/m <sup>3</sup>

## Dust classes

A dust particle with an average size of 1 µm takes almost 7 hours to reach the ground again from a height of 1 metre.

Floating behaviour of dusts					
Diameter [µm]	100	50	10	1	0.1
Sedimentation [cm/s]	25	7	0.3	0.004	0.00009
Drop duration from 1m height [m]	0.07	0.2	5.6	417 (7 h)	18520

With the help of the the fischer hollow drill bit FHD and the vacuum cleaner FVC 35 M of the dust class M, the dust is sucked in directly at the point of origin on the device and thus prevents the dust particles from getting into the air at all. The described extraction

Dust classes acc. to IEC/EN 60335-2-69, based on AA (extract)	AGW-values*	Transmittance (max.)	Disposal
L	> 1 mg/m <sup>3</sup>	< 1 % (filter material only)	–
M	≥ 0.1 mg/m <sup>3</sup>	< 0.1 % (entire system)	low-dust
H	< 0.1 mg/m <sup>3</sup>	< 0.005 % (entire system)	dust-free
additional requirement asbestos	asbestos dusts	< 0.005 % (entire system)	dust-free

system has a dust transmittance of max. 0.1%. According to the German TRGS 504 directive, only vacuum cleaners of dust class M and H are permissible in Germany for industry and trade.

\* AGW = workplace limit

# Assortment and accessories

## Vacuum cleaner FVC 35 M



FVC 35 M

Item	Art.-No.	Voltage [V]	Max. power from suction cup to socket [Watt]	Max. power [Watt]	Max. volume flow [l/s]	Negative pressure [mbar]	Noise pressure [dB(A)]	Container volume [l]	Weight [kg]	Content	Dimensions [cm]
fischer vacuum cleaner FVC 35 M	551924	220-240	2000 (220 – 240V ~)	1400	73*	270*	69	35 gross, 25 dust, 22 water	15.5	1x vacuum cleaner FVC 35 M, 1x suction hose FVC SH ø 35 mm, length 5 m, 2x filter cartridges FVC FC, 1x Polyethylene bag FVC PB	53 x 40 x 56 (network cable length: 800)

\* Measured at motor head

## Cleaning set FVC AP



Hand tube with supplementary air slide



Suction tube



Floor nozzle



Crevice nozzle

Item	Art.-No.	Suitable for	Material	Content	Dimensions
Cleaning set FVC AP	552058	FVC 35 M	Plastic	1x hand tube with supplementary air slide, 2x suction tube, 1x floor nozzle, 1x crevice nozzle	30 cm long with Ø 35 mm 50 cm long with Ø 35 mm 30 cm wide with Ø 35 mm 22 cm long with Ø 35 mm

## Vacuum cleaner FVC Zubehör



Fleece filter bag FVC FB



Polyethylene bag FVC PB



Folded filter cartridges FVC FC



Suction hose FVC SH



Push handle FVC PH

Item	Art.-No.	Sales unit [pcs]	Material	Dimensions	Suitable for
Fleece filter bag FVC FB	552059	5	Fleece	for 35 litre plastic container	FVC 35 M
Polyethylene bag FVC PB	552060	5	Polyethylene	for 35 litre plastic container	FVC 35 M
Folded filter cartridges FVC FC	552061	2	Polyester	filter surface 8600 cm <sup>2</sup>	FVC 35 M
Suction hose FVC SH	552062	1	Polyethylenw	Ø 35 mm, length: 5 m	FVC 35 M
Push handle FVC PH	552063	1	Stainless steel	–	FVC 35 M

## Hollow drill bit FHD

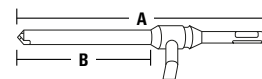

## Hollow drill bit FHD

Item	Art.-No.	Diameter [mm]	Total length A [mm]	Total length B [mm]	Connection	Content	Packaging
FHD 12/200/330	546597	12	330	200	SDS-Plus	1	Clip
FHD 14/250/380	546598	14	380	250	SDS-Plus	1	Clip
FHD 16/250/380	546599	16	380	250	SDS-Plus	1	Clip
FHD 18/320/450	546600	18	450	320	SDS-Plus	1	Clip
FHD Max 16/400/620	546601	16	620	400	SDS-Plus	1	Clip
FHD Max 18/400/620	546602	18	620	400	SDS-Plus	1	Clip
FHD Max 20/400/620	546603	20	620	400	SDS-Plus	1	Clip
FHD Max 24/400/620	546604	24	620	400	SDS-Plus	1	Clip
FHD Max 28/600/820	546605	28	820	600	SDS-Plus	1	Clip
FHD Max 30/600/820	546606	30	820	600	SDS-Plus	1	Clip
FHD Max 35/650/870	546607	35	870	650	SDS-Plus	1	Clip

# All services at a glance.

## Warranty



When you purchase a new tool, you receive 1 year warranty as a B2B-customer and 2 years as an end user in Europe. If justified repairs are arising during this period, we will repair or replace your device free of charge.

## 8 years spare parts availability



We guarantee an 8-year availability of spare parts even after production is discontinued.

## 72 hours repair service



Within 72 hours your machine or accessories will be repaired & maintained and will leave the fischer service factory.

## Online Services



At **[www.fischer-international.com/service](http://www.fischer-international.com/service)** you will find all information about fischer services for our customers.

## Free disposal of old tools



At some point, even the most durable fischer machine has had its day. In this case, we will be happy to take care of the proper disposal for you. To do this, simply contact your dealer or your fischer contact person directly.

## Product & application consulting

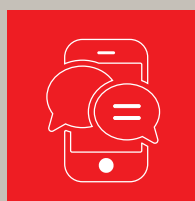

Our qualified staff will be happy to answer any questions you may have about fischer products.



# Process of the fischer service.

## Pack

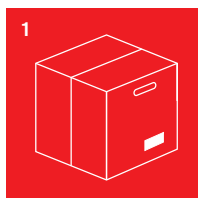

Pack defective machine safely for transport in a stable shipping carton.



## Transport papers



Fill in the transport documents and put them in the transport case of the machine. Please contact your fischer contact person for the necessary documents or download them directly from [www.fischer-international.com/service](http://www.fischer-international.com/service)



## Pick-up

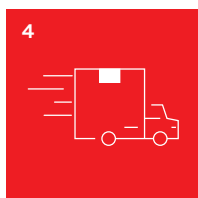

Pick-up at the fastest possible time.



## Order pick-up service

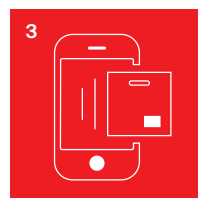

Pick-up is ordered by your fischer contact person or the fischer contact person picks up the goods from you. Parcel service providers should not be commissioned themselves.



## Repair

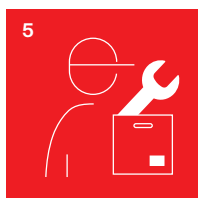

Fast repair in the Service Center maximum within 72 hours after collection of the tool.



## Shipping



Parcel service returns the repaired vacuum cleaner.

More information about the fischer services:  
[www.fischer-international.com/service/toolservice](http://www.fischer-international.com/service/toolservice)



**fischer hollow drill bit.  
For drilling with low dust  
as well as for efficient and  
approved anchoring.**

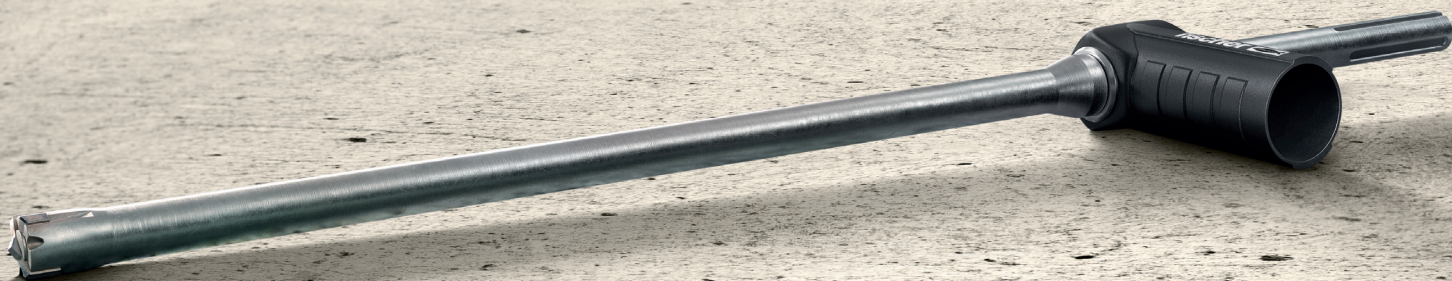

# Our 360° service to you.

From software solutions, to training, to personal consulting. As a reliable partner, we are always happy to assist you with words and deeds.



## Your advantages:

- Our products range from chemical resin systems to steel anchors through to nylon anchors.
- Competence and innovation through own research, development and production.
- Global presence and active sales service in over 100 countries.
- Qualified technical consulting for economical and compliant fastening solutions. Also on-site at the construction site if requested.
- Training sessions, some with accreditation, at your premises or at the fischer academy.
- Design and construction software for demanding applications.

# Design Software fischer FIXPERIENCE.

The fischer design Software FIXPERIENCE gives you safe and reliable support in measuring your projects whether you are a planer, structural engineer or craftsman. Measuring has never been so simple!

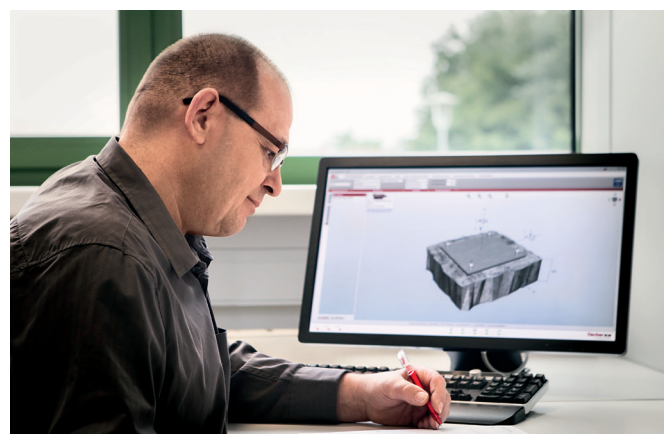

## Software and modules for your daily work.

- The modular design program includes engineering software and application modules.
- The software is based on international design standards (ETAG 001, EC1, EC2, EC3 and EC5), including the national application documents. All common force and measurement units are available.
- Incorrect input will be recognized and the software gives tips to get a correct result. This ensures a safe and reliable design every time.
- The graphical display can easily be rotated through 360°, panned, tilted or zoomed as required.
- The 3D display gives a detailed and realistic image.
- The "live update" feature helps to keep the program up to date ensuring you are always working with the latest version.
- Free download and updates at: [www.fischer.de/fixperience-en](http://www.fischer.de/fixperience-en)



Dealer:

[www.fischer.de](http://www.fischer.de)



**fischer stands for**

FIXING SYSTEMS  
AUTOMOTIVE SYSTEMS  
FISCHERTECHNIK  
CONSULTING  
LNT AUTOMATION

---

**fischerwerke GmbH & Co. KG**  
Klaus-Fischer-Straße 1 · 72178 Waldachtal  
Germany  
T +49 7443 12-0  
[www.fischer.de](http://www.fischer.de) · [info@fischer.de](mailto:info@fischer.de)

---